

For Lease



MILLENNIUM CENTRE

4909 49 STREET
RED DEER, ALBERTA

DEMOGRAPHICS



Population
100,418



Median Age
43



Household Income
\$93,098

BUILDING DETAILS



Parking
280 stalls



Neighbourhood
Downtown



Traffic Count
20,000 vpd

HIGHLIGHTS

- 7 storey downtown office/retail building located across from City Hall in downtown Red Deer with a parkade capacity for 280 vehicles
- Strong tenant mix from financial and legal institution to government office
- RDC off site campus, high trafficked food court
- New major retail tenants

PROPERTY DESCRIPTION

Rates:	Market
Leasable Areas:	Unit 101: Conditionally Leased Unit 106: 1,307 sq. ft. Unit 110: 3,034 sq. ft.
Op Costs & Taxes:	\$15.50 psf (est)
Term:	5 - 10 years
Parking:	Market Rates

HEAD OFFICE
Suite 300, 1324 - 11 Avenue SW
Calgary, Alberta T3C 0M6
Toll Free 1.800.750.6766
AvenueCommercial.com

AVENUE | Commercial
Real Estate Solutions

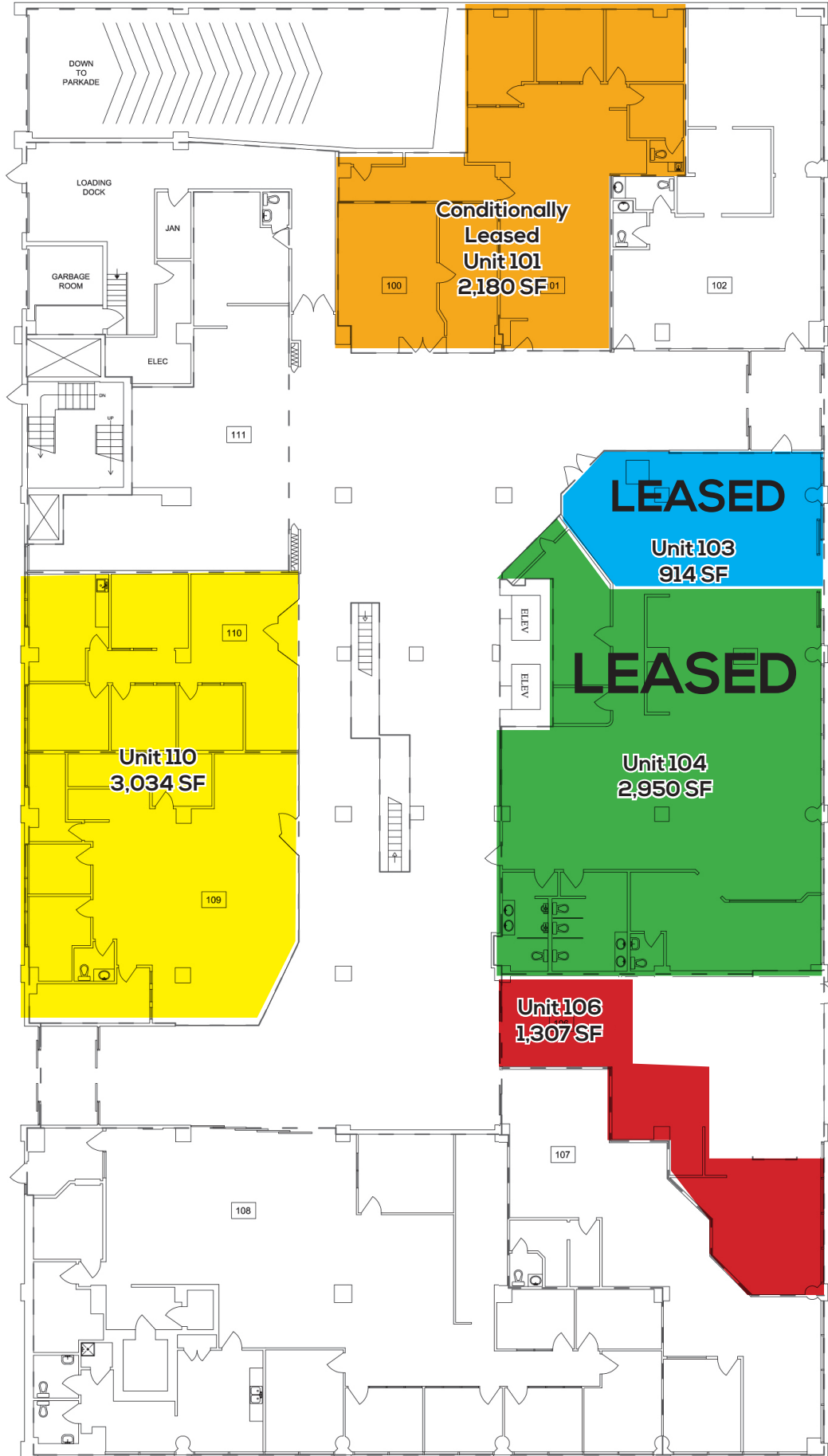

Suite 101 - 2,180 sq. ft. - Former Registry Office



Suite 103 - 914 sq. ft.



Suite 104 - 2,950 sq. ft.

Turnkey restaurant located on the main floor of a 7 storey downtown office/retail building located across from City Hall in downtown Red Deer with a parkade capacity for 280 vehicles



LEASED



Suite 106 - 1,307 sq. ft.



Suite 110 - 3,034 sq. ft.



LOCATION

4909 49 Street, Red Deer, Alberta



CHOOSE YOUR AVENUE

Commercial / Residential / Financing / Property Management / Investments

Steven Butt

President

403.802.6766

sbutt@avenuecommercial.com

This brochure is intended for information purposes only and should not be relied upon for accurate factual information by the recipients hereof. The information contained herein is based on information which Avenue Commercial deems reliable. The information contained herein is subject to change without notice.

AVENUE | Commercial
Real Estate Solutions

HEAD OFFICE

Suite 300, 1324 – 11 Avenue SW
Calgary, Alberta T3C 0M6

Main 403.802.6766

Toll Free 800.750.6766

AvenueCommercial.com

