

For Sale

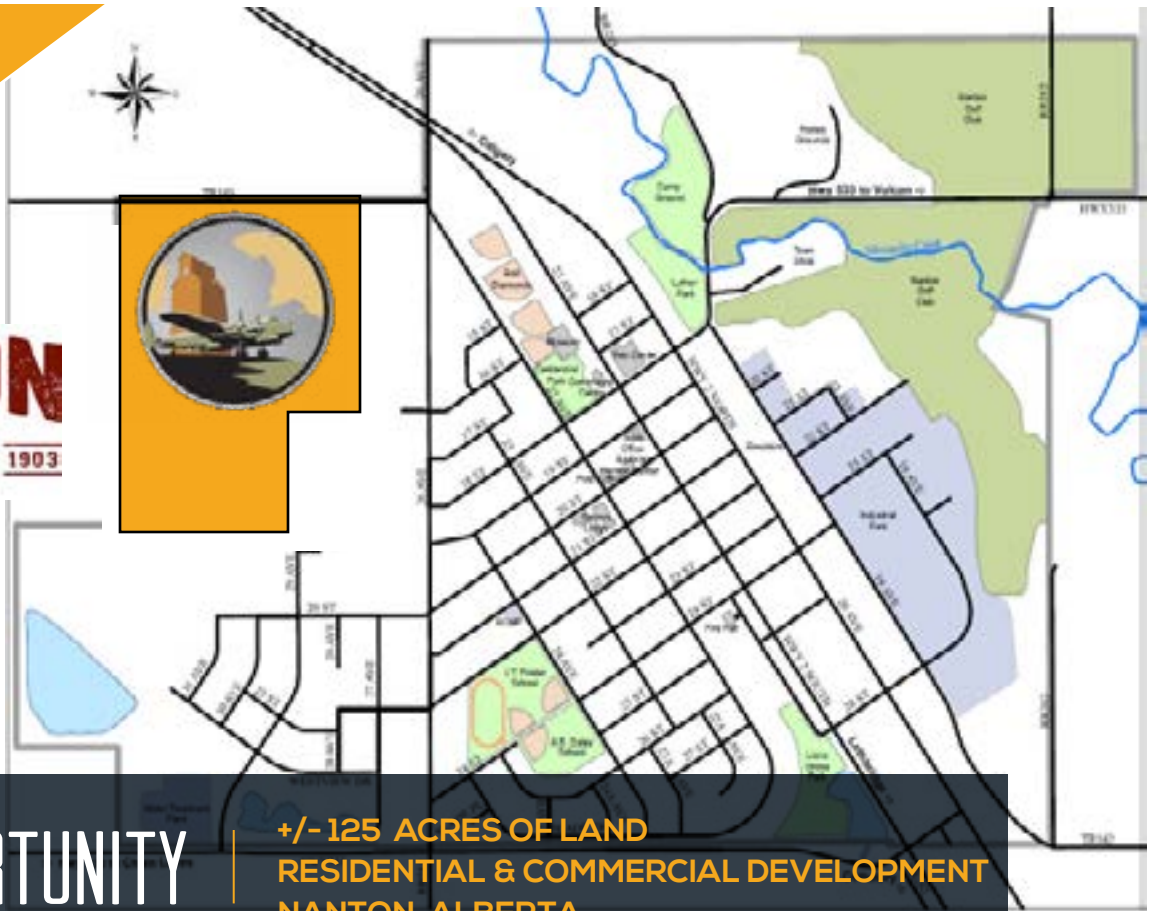

GREAT OPPORTUNITY

**+/- 125 ACRES OF LAND
RESIDENTIAL & COMMERCIAL DEVELOPMENT
NANTON, ALBERTA**

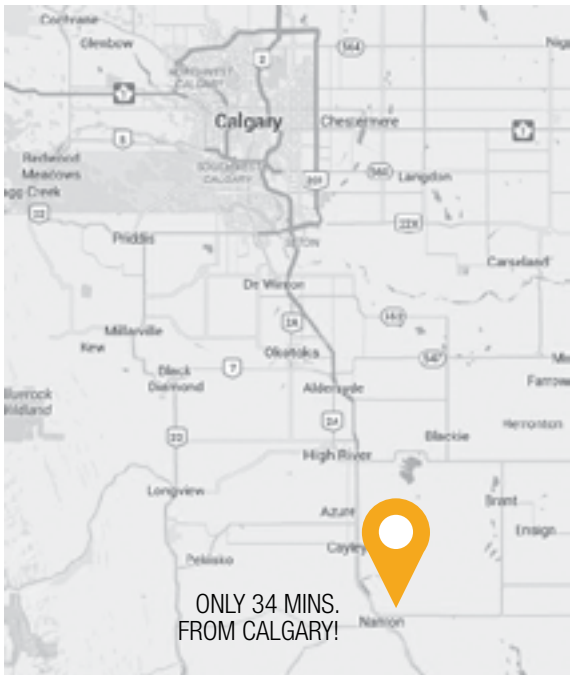

ONLY 34 MINS.
FROM CALGARY!

HIGHLIGHTS

Situated in the Town of Nanton the development site consists of approximately 125 acres. This land is being sold as a “Turn-Key” Development with the ASP already approved by the Town on Nanton and Phase 1 of the 7 Phase development is ready to begin. The development plan consists of a Commercial Village Centre, Low and Medium Density Residential Housing, Parks and Recreational Space, School and Municipal Reserve.

PROPERTY DESCRIPTION

Price:	\$45,000 per acre
Size:	+/-125 Acres
Zoning:	AT (Agricultural Transitional)

DEMOGRAPHICS



Population
2,132

Household Income
\$23,809

Median Age
49.4

HEAD OFFICE
Suite 300, 1324 – 11 Avenue SW
Calgary, Alberta T3C 0M6
Toll Free 1.800.750.6766
AvenueCommercial.com

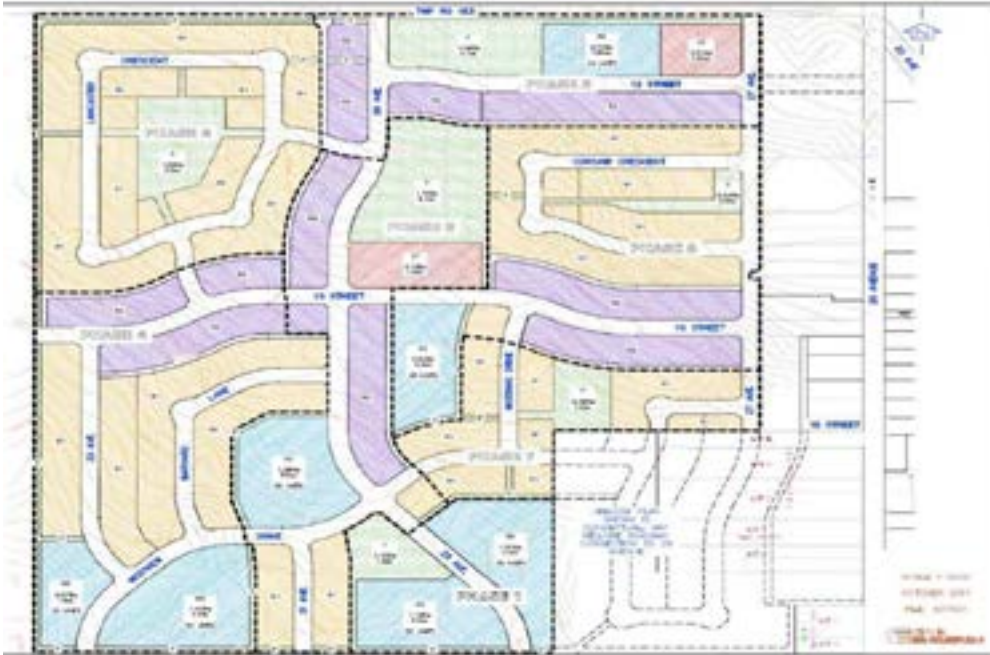
AVENUE | Commercial
Real Estate Solutions



PROPOSED DEVELOPMENT MIX

Type of Dwelling	Number of Dwellings	Population
With Commercial	12	28
Multifamily	224	515
Two Family	164	377
Single Family	231	531
Total:	631	1451

CHOOSE YOUR AVENUE

Commercial / Residential / Financing / Property Management / Investments

Steven Butt
President

403.802.6766
sbutt@avenuecommercial.com

This brochure is intended for information purposes only and should not be relied upon for accurate factual information by the recipients hereof. The information contained herein is based on information which Avenue Commercial deems reliable. The information contained herein is subject to change without notice.